

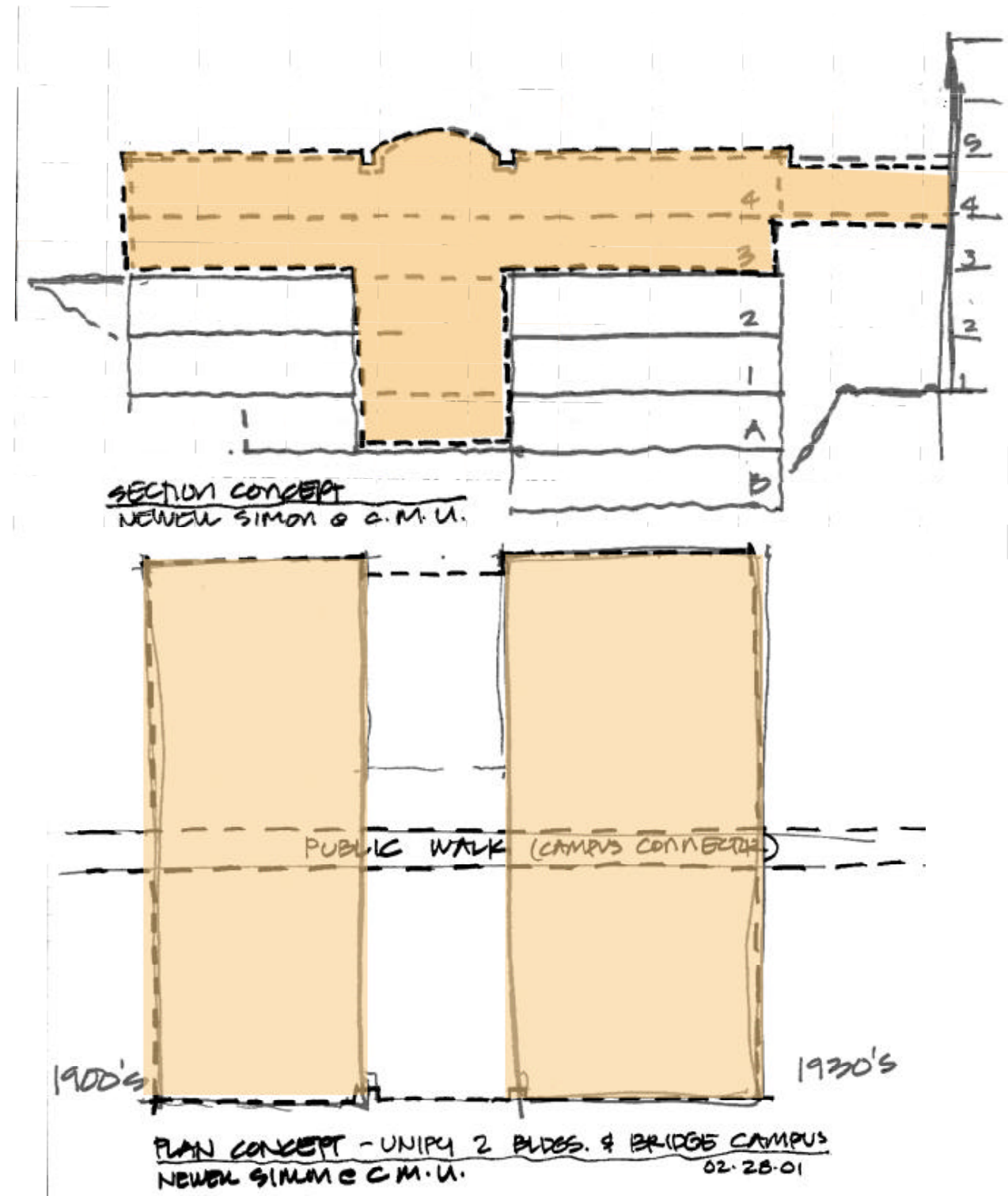

# NEWELL-SIMON HALL, Carnegie Mellon

SPACE TYPE	ASF	%
<b>Instructional</b>		
110 Classroom	650	1%
250 Research Lab	44,203	43%
<b>Office</b>		
300 Faculty, Student, Staff	46,525	45%
<b>Study Areas</b>		
420 Library	156	0%
<b>Services</b>		
600 Auditorium, Louges, Vending, etc.	8,382	8%
<b>General Building Support</b>		
700 Supply, storage, etc.	3,600	3%
<b>TOTAL BUILDING GROSS SQUARE FEET</b>	<b>103,516</b>	<b>100%</b>
<b>NET/GROSS RATIO</b>	<b>0.60</b>	



Building Organization  
Diagram



# NEWELL-SIMON HALL, Carnegie Mellon

ROOM NO.	ROOM USE CODE	ASF	DESCRIPTION
<b>BASEMENT LEVEL</b>			
B102	720	923	Shop (other)
B104	635	270	Storage Room
B105	790	1,033	Materials Shipping or Receiving Rm
B500	250	4,960	Research Laboratory
B504	250	554	Research Laboratory
B506	250	539	Research Laboratory
B510	250	1,058	Research Laboratory
B512	250	597	Research Laboratory
B520	250	1,411	Research Laboratory
B524	250	144	Research Laboratory
B526	255	331	Storage Room
<b>TOTAL ASSIGNABLE AREA</b>		<b>11,820</b>	

Newell-Simon Hall  
B Basement Level

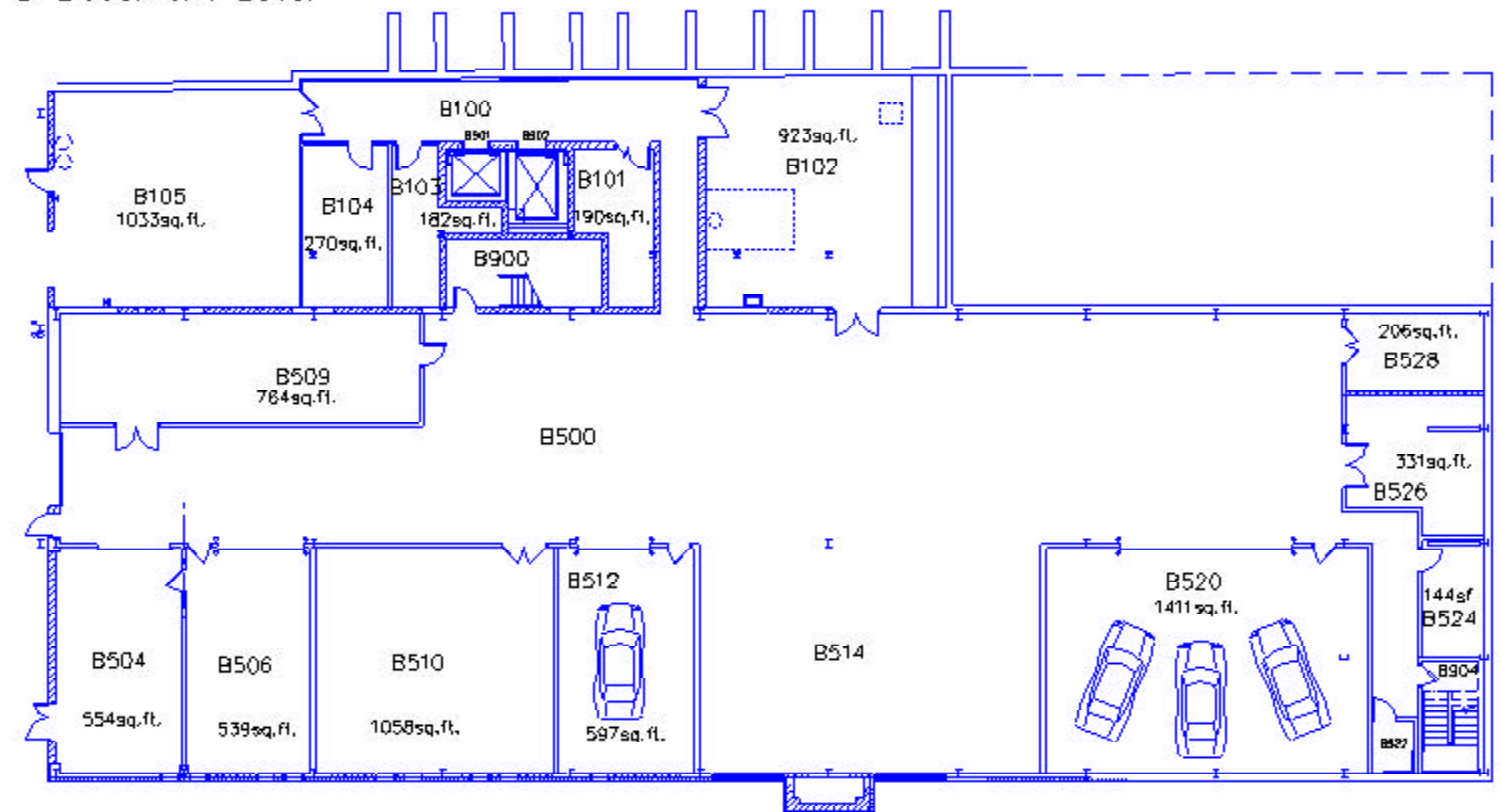

## Basement Floor

11,820 ASF

17,475 GSF

Net / Gross .67



# NEWELL-SIMON HALL, Carnegie Mellon

ROOM NO.	ROOM USE CODE	ASF	DESCRIPTION
<b>LOWER LEVEL</b>			
A001	650	121	Lounge
A003	655	44	Vending Machines
A006	315	80	Storage Room
A007	315	67	Duplicating Room
A100	250	3,774	Research Laboratory
A401	250	1,100	Research Laboratory
A403	250	1,533	Research Laboratory
A406	250	342	Research Laboratory
A407	250	758	Research Laboratory
A408	250	2,035	Research Laboratory
A408A	255	76	Storage Room
A409	310	138	Staff Office
A410	250	247	Research Laboratory
A411	310	141	Staff Office
A413	310	142	Faculty Office
A417	250	267	Research Laboratory
A421	310	145	Faculty Office
A423	310	146	Faculty Office
A427	250	327	Research Laboratory
A428	250	338	Research Laboratory
A431	250	334	Research Laboratory
A432	250	338	Research Laboratory
A501	250	241	Research Laboratory
A502	250	232	Research Laboratory
A503	315	141	Network Closet
A504	250	501	Research Laboratory
A505	350	135	Research Laboratory
A507	350	253	Conference Room (other)
A513	250	831	Research Laboratory
A519	250	819	Research Laboratory
A521	720	289	Shop (other)
A525	310	141	Staff Office
A527	310	142	Faculty Office
A529	250	332	Research Laboratory
<b>TOTAL ASSIGNABLE AREA</b>		<b>16,550</b>	

Newell-Simon Hall  
A Lower Level

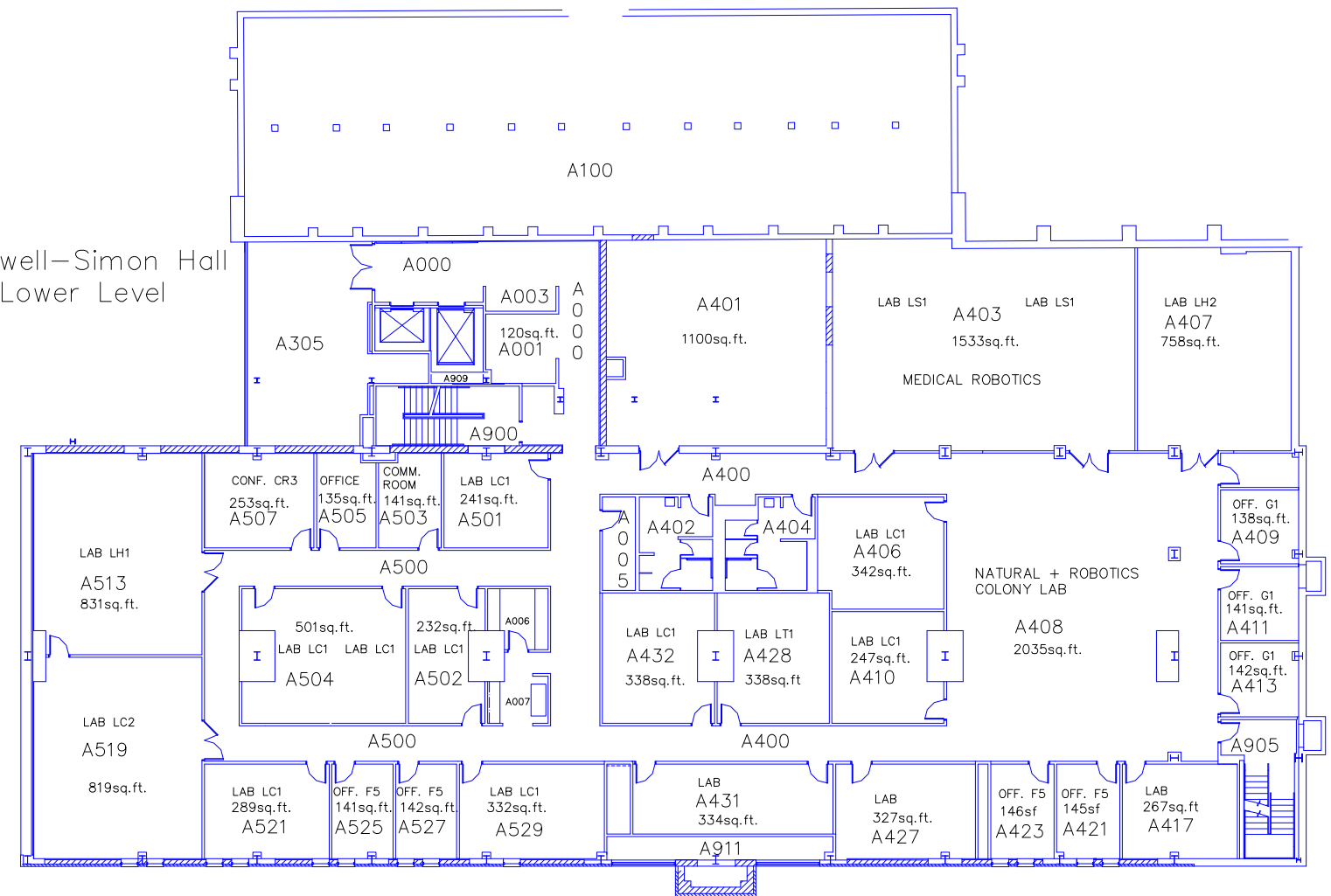

**Lower Level**  
16,550 ASF  
22831 GSF  
Net / Gross .72



# NEWELL-SIMON HALL, Carnegie Mellon

ROOM NO.	ROOM USE CODE	ASF	DESCRIPTION
<b>FIRST FLOOR</b>			
1001	650	121	Lounge
1002	655	39	Vending Machines
1101	310	142	Faculty Office
1103	310	148	Faculty Office
1105	310	138	Staff Office
1107	310	96	Staff Office
1109	350	472	Conference Room (other)
1111	310	162	Staff Office
1113	310	172	Staff Office
1200	250	5,158	Research Laboratory
1201	250	365	Electronics Shop
1202	250	514	Research Laboratory
1205	310	120	Staff Office
1208	250	426	Research Laboratory
1305	610	1,178	Auditorium
1401	720	1,178	Shop (other)
1403	250	1,178	Research Laboratory
1501	310	403	Staff Office
1502	250	517	Research Laboratory
1503	355	145	Network Closet
1505	350	276	Conference Room (other)
1507	350	982	Conference Room (other)
1509	315	139	Duplicating Room
1511	310	138	Staff Office
1513	650	854	Lounge
1515	310	141	Staff Office
1517	310	230	Staff Office
1602	250	535	Research Laboratory
1604	250	227	Research Laboratory
1609	250	428	Research Laboratory
1611	310	137	Research Office
1612	250	444	Research Laboratory
1613	310	212	Graduate Student Office
1615	310	136	Staff Office
1617	310	134	Staff Office
1109A	355	13	Closet or Coat Room
1109B	355	20	Closet or Coat Room
1109C	355	20	Closet or Coat Room
1201A	250	110	Research Laboratory
1502A	310	139	Staff Office
1502B	310	144	Graduate Student Office
1502C	310	140	Faculty Office
1502D	310	236	Faculty Office
1502E	310	160	Faculty Office
1502F	310	188	Staff Office
1602A	310	138	Staff Office
1602B	310	139	Staff Office
1602C	310	150	Staff Office
1602D	310	227	Faculty Office
1604A	310	136	Staff Office
1604B	310	139	Staff Office
1604C	310	236	Graduate Student Office
1604D	310	227	Staff Office
1612A	310	137	Staff Office
1612B	310	137	Staff Office
1612C	310	207	Faculty Office
1612D	310	142	Staff Office
1612E	310	224	Graduate Student Office
2001	650	121	Lounge
<b>TOTAL ASSIGNABLE AREA</b>		<b>21,215</b>	

Newell-Simon Hall  
First Floor

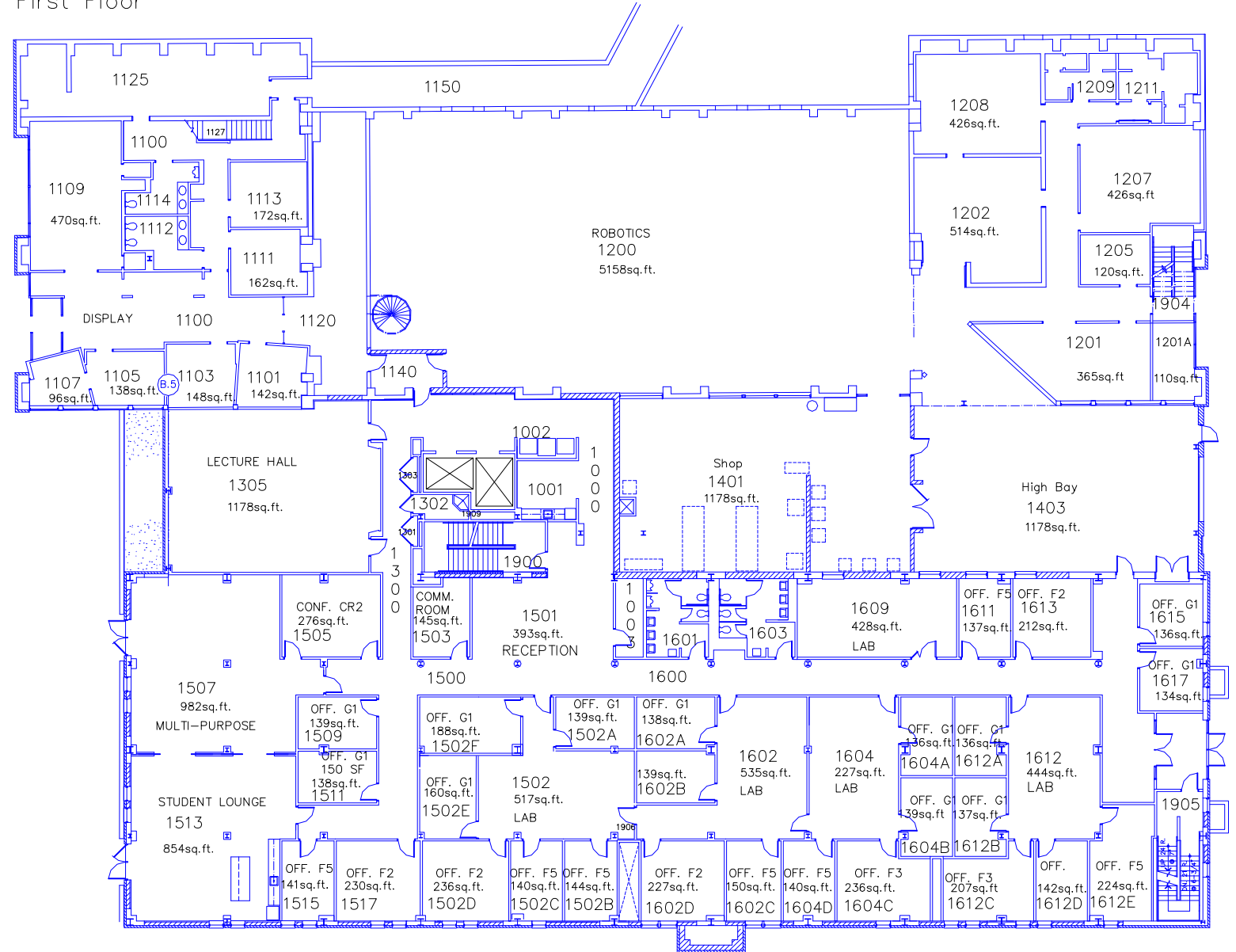

## First Floor

21,215 ASF

33284 GSF

Net / Gross .64



# NEWELL-SIMON HALL, Carnegie Mellon

ROOM NO.	ROOM USE CODE	ASF	DESCRIPTION
<b>SECOND FLOOR</b>			
2002	315	80	Closet or Coat Room
2003	655	39	Vending Machines
2101	310	94	Staff Office
2102	310	230	Graduate Student Office
2103	310	176	Staff Office
2104	315	78	Network Closet
2105	310	175	Staff Office
2107	310	102	Staff Office
2109	310	236	Faculty Office
2111	310	145	Faculty Office
2113	310	142	Faculty Office
2115	310	171	Faculty Office
2117	315	127	Duplicating Room
2119	315	148	Network Closet
2121	315	126	Network Closet
2201	310	137	Staff Office
2202	310	348	Graduate Student Office
2203	310	195	Staff Office
2204	250	462	Research Laboratory
2205	310	195	Staff Office
2207	310	176	Staff Office
2209	310	166	Staff Office
2211	310	172	Staff Office
2215	315	107	Network Closet
2216	310	110	Staff Office
2303	315	6	Network Closet
2501	315	135	Duplicating Room
2502	250	685	Research Laboratory
2503	350	140	Conference Room (other)
2504	250	997	Research Laboratory
2507	350	260	Conference Room (other)
2602	250	1,348	Research Laboratory
2609	350	450	Conference Room (other)
2611	310	150	Graduate Student Office
2612	310	150	Staff Office
2613	250	250	Research Laboratory
2614	310	180	Staff Office
2617	310	144	Staff Office
2619	310	144	Staff Office
2620	250	360	Research Laboratory
2621	310	125	Faculty Office
2502A	310	150	Faculty Office
2502B	310	150	Staff Office
2502C	310	240	Faculty Office
2504A	310	250	Staff Office
2504B	310	150	Staff Office
2504C	310	150	Staff Office
2504D	310	150	Staff Office
2504E	250	240	Research Laboratory
2504F	310	195	Staff Office
2602A	310	150	Staff Office
2602B	310	150	Staff Office
2602C	310	240	Faculty Office
2602D	310	150	Staff Office
2602E	310	150	Staff Office
2602F	310	150	Staff Office
2602G	310	218	Graduate Student Office
2602H	310	150	Staff Office
2602I	310	190	Staff Office
2602J	310	230	Staff Office
2602K	310	150	Staff Office
2602L	310	150	Staff Office
2620A	310	150	Staff Office
2620B	310	150	Staff Office
2620C	310	240	Staff Office
<b>TOTAL ASSIGNABLE AREA</b>		<b>13,954</b>	



13,954 ASF  
33,013 GSF  
Net / Gross .42



# NEWELL-SIMON HALL, Carnegie Mellon

ROOM NO.	ROOM USE CODE	ASF	DESCRIPTION
<b>THIRD FLOOR</b>			
3001	350	380	Conference Room (other)
3002	110	650	Classroom 25-60 people
3009	315	28	Storage Room
3101	310	155	Administrative Office
3102	315	106	Duplicating Room
3103	310	155	Administrative Office
3104	310	150	Administrative Office
3105	310	196	Administrative Office
3106	310	150	Administrative Office
3107	310	150	Faculty Office
3108	310	150	Graduate Student Office
3109	310	150	Faculty Office
3110	310	150	Graduate Student Office
3111	310	150	Faculty Office
3113	310	260	Faculty Office
3115	310	196	Faculty Office
3117	310	196	Faculty Office
3119	310	290	Faculty Office
3121	310	150	Staff Office
3122	310	144	Staff Office
3123	310	150	Graduate Student Office
3124	310	144	Graduate Student Office
3125	310	150	Graduate Student Office
3126	315	100	Storage Room
3127	310	150	Graduate Student Office
3128	310	150	Graduate Student Office
3129	650	253	Lounge
3201	310	196	Staff Office
3202	315	260	Duplicating Room
3203	310	196	Staff Office
3205	310	196	Faculty Office
3206	250	1,340	Research Laboratory
3207	310	150	Faculty Office
3208	250	287	Research Laboratory
3209	310	150	Staff Office
3211	310	150	Staff Office
3213	310	260	Faculty Office
3215	310	192	Faculty Office
3216	310	144	Staff Office
3217	310	170	Faculty Office
3218	310	144	Staff Office
3220	310	125	Staff Office
3301	315	5	Closet or Coat Room
3304	610	335	Auditorium
3305	350	670	Conference Room (other)
3400	650	2,793	Lounge
3403	630	926	Pantry
3501	350	302	Conference Room (other)
3503	715	177	Network Closet
3507	310	150	Staff Office
3508	315	178	Duplicating Room
3509	310	150	Staff Office
3511	310	150	Faculty Office
3513	310	275	Faculty Office
3515	310	170	Faculty Office
3517	310	213	Faculty Office
3519	310	365	Administrative Office
3521	310	192	Faculty Office
3523	310	183	Faculty Office
3525	310	139	Faculty Office
3526	250	587	Research Laboratory
3527	310	140	Administrative Office
3529	310	137	Faculty Office
3531	310	178	Faculty Office
3601	310	185	Faculty Office
3602	250	189	Research Laboratory
3603	310	187	Faculty Office
3605	310	179	Faculty Office
3607	310	140	Staff Office
3609	310	140	Administrative Office
3611	310	138	Staff Office
3612	310	1,001	Graduate Student Office
3613	310	140	Faculty Office
3615	310	178	Faculty Office
3101A	315	32	Storage Room
3526A	310	139	Faculty Office
3526B	310	139	Staff Office
3602A	250	189	Research Laboratory
3602B	250	201	Research Laboratory
3602C	250	532	Research Laboratory
3612A	310	140	Graduate Student Office
3612B	310	128	Administrative Office
3612C	310	136	Staff Office
3612D	310	207	Faculty Office
3612E	310	138	Staff Office
<b>TOTAL ASSIGNABLE AREA</b>		<b>21,886</b>	

Newell-Simon Hall  
Third Floor

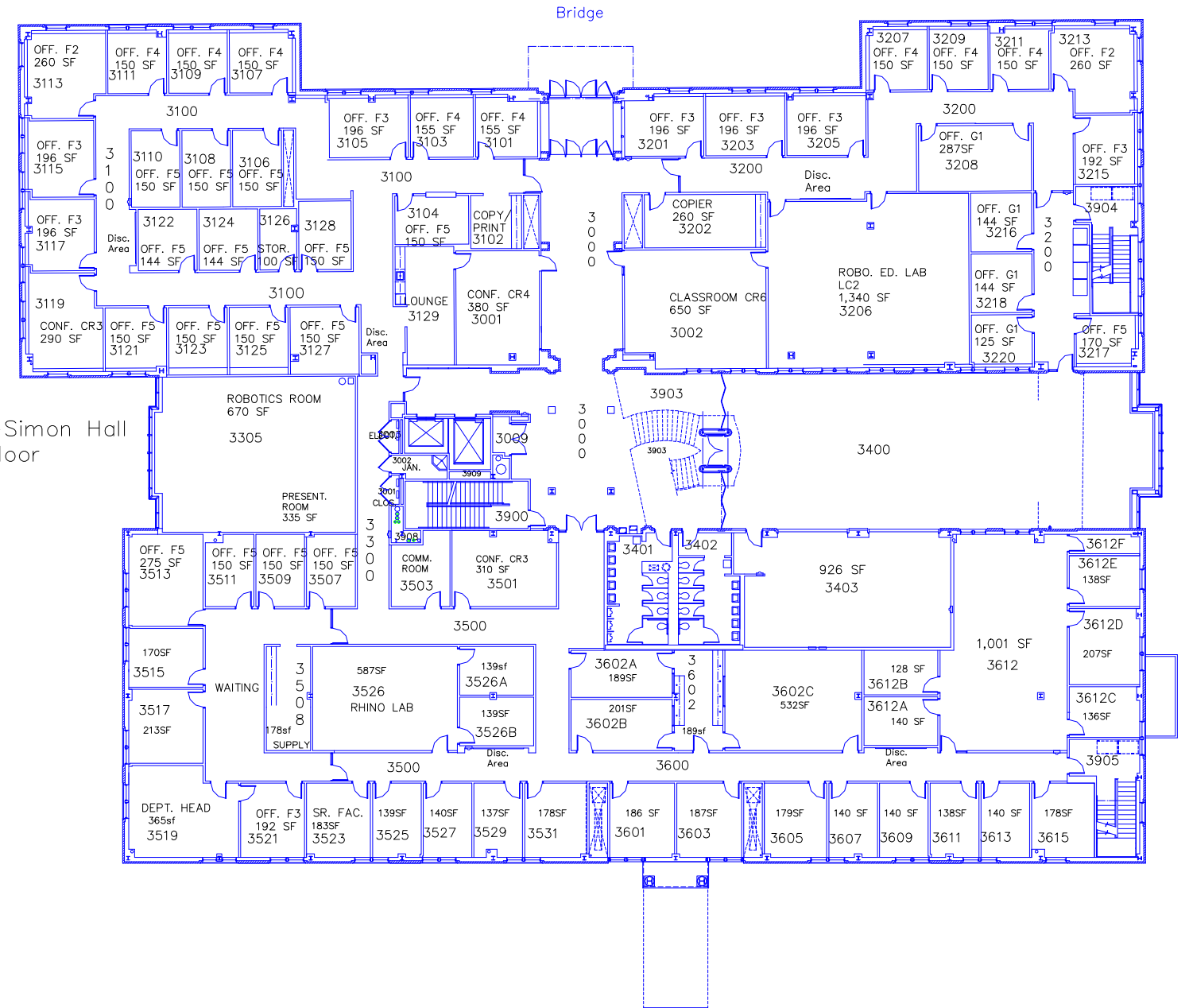

**Third Floor**  
21,886 ASF  
33,298 GSF  
Net / Gross .66



# NEWELL-SIMON HALL, Carnegie Mellon

ROOM NO.	ROOM USE CODE	ASF	DESCRIPTION
<b>FOURTH FLOOR</b>			
4101	310	225	Faculty Office
4102	315	114	Duplicating Room
4103	310	225	Faculty Office
4105	310	190	Faculty Office
4106	310	150	Graduate Student Office
4107	310	160	Faculty Office
4108	310	150	Graduate Student Office
4109	310	144	Faculty Office
4111	310	144	Faculty Office
4113	350	360	Conference Room (other)
4115	310	165	Faculty Office
4117	310	165	Faculty Office
4119	310	350	Administrative Office
4121	310	288	Staff Office
4122	310	144	Staff Office
4124	310	144	Graduate Student Office
4125	310	144	Graduate Student Office
4126	310	144	Graduate Student Office
4127	310	150	Graduate Student Office
4128	310	144	Graduate Student Office
4129	650	250	Lounge
4130	310	144	Research Office
4200	250	1,200	Research Laboratory
4201	350	350	Conference Room (other)
4203	310	150	Faculty Office
4205	310	150	Faculty Office
4207	310	144	Staff Office
4208	310	150	Graduate Student Office
4209	310	144	Staff Office
4210	250	150	Research Laboratory
4211	310	144	Staff Office
4212	250	150	Research Laboratory
4213	310	240	Faculty Office
4215	310	150	Graduate Student Office
4217	310	150	Staff Office
4219	310	125	Staff Office
4221	310	150	Staff Office
4222	310	150	Graduate Student Office
4223	310	150	Faculty Office
4224	315	160	Storage Room
4225	310	150	Faculty Office
4227	310	150	Staff Office
4229	310	150	Faculty Office
4231	310	140	Staff Office
4303	310	225	Administrative Office
4305	310	225	Administrative Office
4306	310	126	Administrative Office
4307	310	225	Administrative Office
4501	420	156	Library (other)
4502	310	350	Staff Office
4503	310	133	Administrative Office
4504	315	138	Storage Room
4505	250	145	Research Laboratory
4506	310	138	Graduate Student Office
4507	315	126	Network Closet
4508	310	138	Graduate Student Office
4509	310	150	Staff Office
4511	310	150	Staff Office
4513	350	315	Conference Room (other)
4515	310	220	Faculty Office
4517	310	180	Staff Office
4519	310	365	Administrative Office
4521	310	150	Staff Office
4522	310	150	Graduate Student Office
4523	310	150	Faculty Office
4524	310	150	Graduate Student Office
4525	310	150	Faculty Office
4526	310	150	Administrative Office
4527	310	150	Staff Office
4529	310	140	Administrative Office
4531	310	150	Research Office
4533	310	182	Faculty Office
4602	650	200	Lounge
4604	250	250	Research Laboratory
4605	310	150	Staff Office
4606	250	220	Research Laboratory
4607	310	150	Staff Office
4609	310	150	Faculty Office
4611	310	150	Staff Office
4615	310	144	Faculty Office
4617	310	144	Faculty Office
4619	310	125	Faculty Office
4621	310	198	Faculty Office
4622	250	250	Research Laboratory
4623	310	150	Faculty Office
4625	310	150	Staff Office
4626	250	250	Research Laboratory
4627	310	150	Faculty Office
4629	310	150	Staff Office
4631	310	182	Faculty Office
4632	350	234	Conference Room (other)
4000B	650	838	Lounge
4502A	315	138	Duplicating Room

TOTAL ASSIGNABLE AREA 18,091

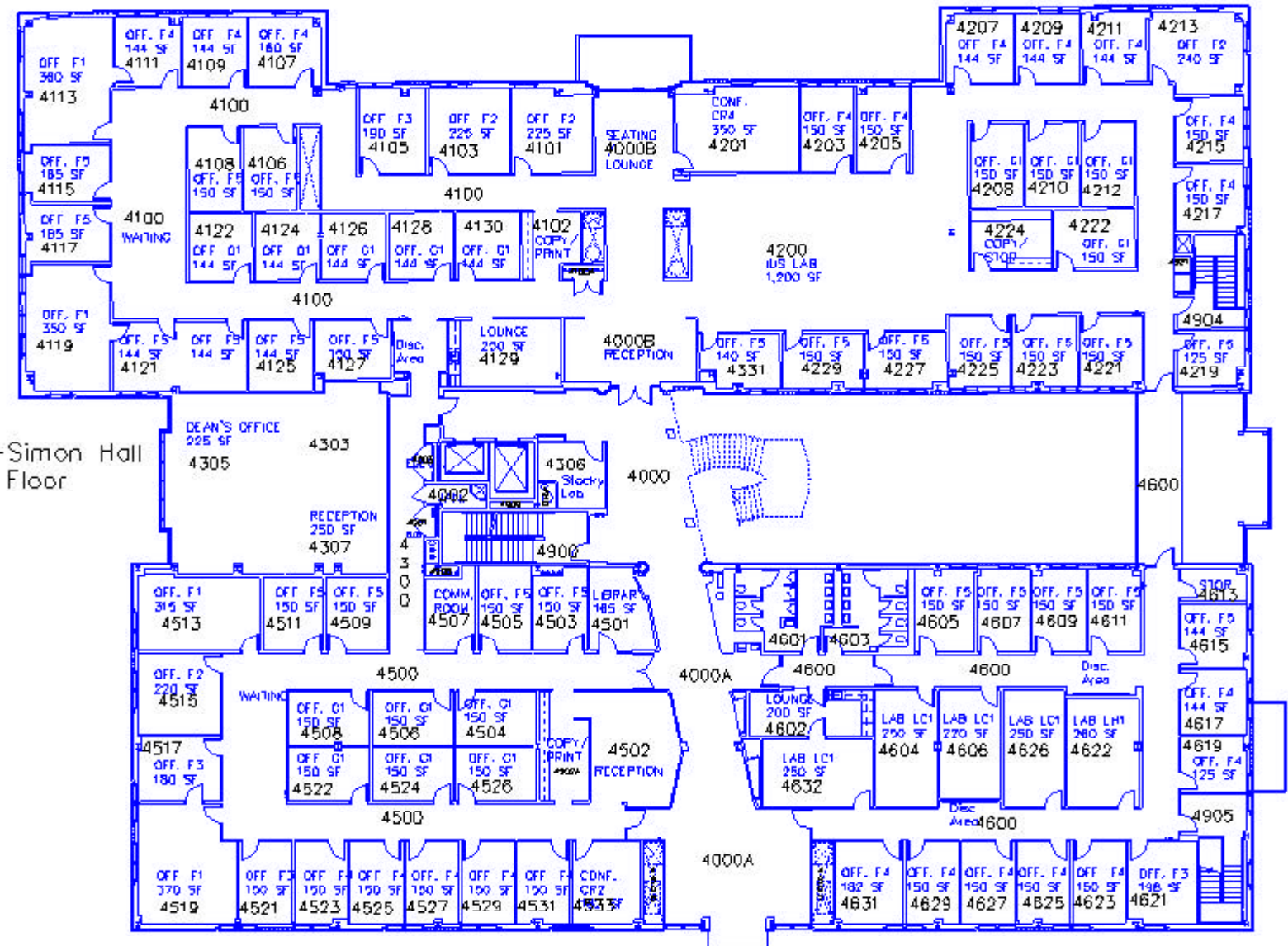

Newell-Simon Hall  
Fourth Floor

## Fourth Floor

18,091 ASF

33,301 GSF

Net / Gross .54